



Dimensions and weights		
Width		
Including packaging	[mm]	580
Excluding packaging	[mm]	515
Depth		
Including packaging	[mm]	740
Excluding packaging	[mm]	599
Height		
Including packaging	[mm]	830
Excluding packaging	[mm]	627
Weight		
Including packaging	[kg]	57
Excluding packaging	[kg]	45
Safety clearances		
Rear	[mm]	50
Right	[mm]	50
Left (larger gap recommended for servicing)	[mm]	50
Top (for ventilation)	[mm]	500

Height with easyTOUCH panel

Appliances with an easyTOUCH panel are 20 mm higher than the specified value.

Electrical connected load ratings

3N~ 400V 50/60Hz (3/N/PE)		
Rated power consumption	[kW]	5,7
Convection power	[kW]	5,4
Motor power	[kW]	0,25
Rated current	[A]	11,8
Fuse	[A]	16
Recommended conductor cross-section for wires laid uncovered in air up to 5 m in length.	[mm ²]	5G2.5
3~ 230V 50/60Hz (3/PE)		
Rated power consumption	[kW]	5,7
Convection power	[kW]	5,4
Motor power	[kW]	0,25
Rated current	[A]	23,5
Fuse	[A]	25
Recommended conductor cross-section for wires laid uncovered in air up to 5 m in length.	[mm ²]	4G4
3~ 200V 50/60Hz (3/PE)		
Rated power consumption	[kW]	5,7
Convection power	[kW]	5,4
Motor power	[kW]	0,25
Rated current	[A]	27,0
Fuse	[A]	32
Recommended conductor cross-section for wires laid uncovered in air up to 5 m in length.	[mm ²]	4G4
1N~ 230V 50/60Hz (1/N/PE)		
Rated power consumption	[kW]	3,0
Convection power	[kW]	2,7
Motor power	[kW]	0,25
Rated current	[A]	13,1
Fuse	[A]	16
Recommended conductor cross-section for wires laid uncovered in air up to 5 m in length.	[mm ²]	3G2.5

Heat output			
Heat output			
Latent heat	[kJ/h]	1000	(0.28 kW)
Sensible heat	[kJ/h]	1100	(0.31 kW)

Water connection		
Water supply (cold only)		
Shut-off device	With EA (verifiable) check valve and dirt filter	
Water supply		
Without CONVOClean system	2 x G 3/4", permanent connection recommended	
With CONVOClean system		
Flow pressure		
Without CONVOClean system	[kPa]	200 - 600 (2 - 6 bar)
With CONVOClean system	[kPa]	300 - 600 (3 - 6 bar)
Water drain		
drain version	permanent connection (recommended) or funnel waste trap	
Type	DN	40

Water quality		
water quality for general use	drinking water quality (install water treatment unit if necessary)	
Hardness for injection		
German degrees of hardness (general hardness: GH)	[°dH]	4 - 7
French degrees of hardness	[TH]	7 - 13
English degrees of hardness	[°e]	5 - 9
International	[ppm]	70 - 125
Chemical	[mmol/l]	0,7 - 1,3
Hardness for condenser, cleaning		
German degrees of hardness (general hardness: GH)	[°dH]	4 - 20
French degrees of hardness	[TH]	7 - 35
English degrees of hardness	[°e]	5 - 25
International	[ppm]	70 - 360
Chemical	[mmol/l]	0,7 - 3,6
Properties		
temperature (T)	[°C]	max. 40
conductivity	[µS/cm]	min. 20
pH		6,5 - 8,5
Cl ⁻	[mg/l]	max. 100
SO ₄ ²⁻	[mg/l]	max. 150
Fe	[mg/l]	max. 0.1
Carbonate hardness (KH)	[°dH]	Low GH

Maximum permissible loading weight		
GN (containers, shelf-grills, baking trays)		
Per combi steamer	[kg]	13
Per shelf	[kg]	5

Capacity		
Quantity		
GN 2/3 depth 40 mm	[Qty]	6
GN 2/3 depth 65 mm	[Qty]	4
Plate up to Ø 28 cm	[Qty]	4

Appliance technical standards		
Degree of protection	IPX4	
Approval mark according to national regulations	TÜV/GS, DIN GOST TÜV, SVGW	
Noise emission		
Measured	[dBA]	max. 60

Appliance with standard controls

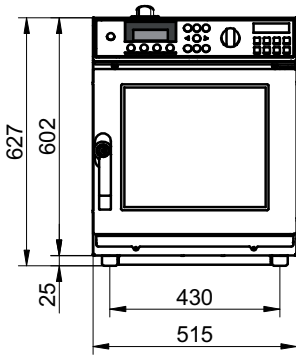

Appliance with easyTOUCH controls

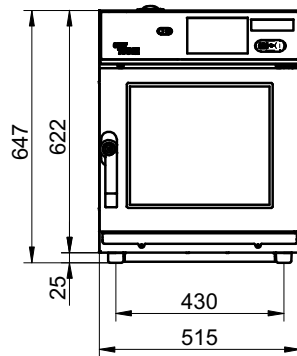

Side view

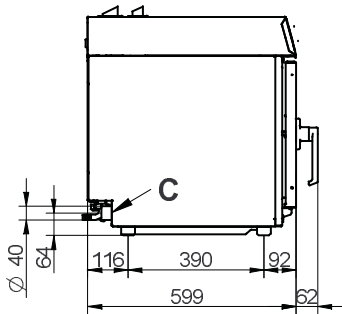

View from above with wall clearances

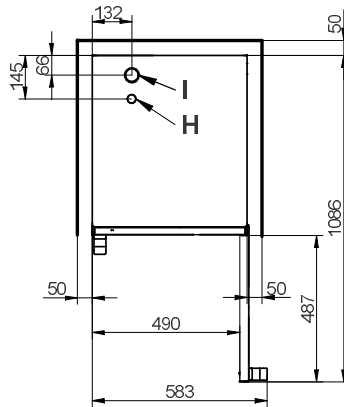

Connections on the underside

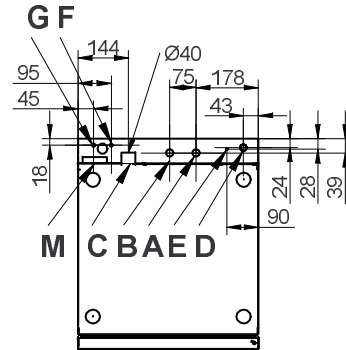

Meaning of labeled elements

A	Water connection Soft water G3/4"	E	Equipotential bonding	H	Air vent
B	Water connection Cold water G3/4"	F	Nozzle detergent connection (Neutralizer)	I	Ventilation port
C	Drain connection DN 40	G	Cleaning agent connection (Cleaner)	M	Overflow 60 x 20
D	Electrical supply				

This document is to be used solely for planning purposes. Please refer to the Installation manual for instructions on installation and positioning.

