



WELCOME
TO A NEW ERA

zumex®

ZUMEX PRESENTS
A NEW CONCEPT
PUSH&JUICE

Forget everything you know about juicers.
One button will change everything.

Enjuice your life!





PUSH&JUICE

Things were never so easy

Imagine pushing just one button and having fresh juice squeezed directly into the glass?

As simple and as natural as that.

Making a juice becomes a breeze with Soul, giving way to a new era for professional juicers.

A new concept with which you will enjoy the essence of a perfect juice.

PUSH&JUICE

Nunca fue tan fácil

¿Imaginas pulsar sólo un botón y tener un zumo recién exprimido directo en el vaso?

Así de sencillo, así de natural.

Soul simplifica al máximo la forma de hacer un zumo y da paso a una nueva era para las exprimidoras profesionales.

Un nuevo concepto con el que disfrutarás de la esencia de un zumo perfecto.

PUSH&JUICE

Nie war es so einfach

Auf einen Tastendruck ein Glas frisch gepresster Saft?

So einfach, so natürlich.

Soul macht die Safterstellung zu einem Kinderspiel und leitet eine neue Ära der professionellen Saftpressen ein.

Ein neuartiges Konzept für perfekten Saft.

PUSH&JUICE

Jamais cela n'a été aussi facile

Imaginez-vous qu'en appuyant sur un seul bouton vous obtiendrez un jus fraîchement pressé, directement dans le verre ?

Si simple, si naturel.

Soul simplifie au maximum la façon de faire un jus de fruit et fait entrer les presse-agrumes professionnels dans une nouvelle ère.

Un nouveau concept pour apprécier l'essence d'un jus parfait.

PUSH&JUICE

Non è mai stato così facile

Riesci ad immaginare di avere un succo appena spremuto direttamente nel bicchiere, premendo soltanto un pulsante?

Facile e naturale.

Soul semplifica al massimo il modo di fare un succo e apre le porte a una nuova era per le macchine spremiagrumi professionali.

Un nuovo concetto che ti permetterà di gustare l'essenza di un succo perfetto.

CONICAL SYSTEM SOUL IS INSIDE

Cold body and warm soul.
That is the secret of a perfect juice.
The combination of cutting-edge
technology, the cleanest cut and
meticulous care of the fruit leads to
perfection in every drop squeezed
by Soul.

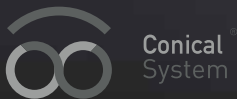

Pat. Pend: P201331180. PCT/EP/2013/070494



CONICAL SYSTEM. EL ALMA ESTÁ DENTRO

Cuerpo frío y alma cálida. Ese es el secreto de un zumo perfecto. La combinación de la tecnología más avanzada, el corte más limpio y un cuidado exigente de la fruta, hace que cada gota exprimida por Soul sea perfecta.

CONICAL SYSTEM. L'ÂME EST L'INTÉRIEUR

Corps froid et intérieur chaud. Tel est le secret d'un jus parfait. L'alliance entre une technologie d'avant-garde, une coupe plus propre et un fruit choyé fait que chaque goutte pressée par Soul est parfaite.

CONICAL SYSTEM. DIE SEELE BEFINDET SICH IM INNERSTEN

Kühler Körper und warme Seele. Das Geheimnis von perfektem Saft. Die Kombination von modernster Technologie, sauberem Schnitt und schonender Behandlung der Frucht erzielt die Perfektion von jedem mit Soul ausgepressten Tropfen Saft.

CONICAL SYSTEM. L'ANIMA È DENTRO

Corpo freddo, anima calda. Questo è il segreto di un succo perfetto. La combinazione della tecnologia più avanzata, del taglio più pulito e di un trattamento esigente della frutta, fa in modo che ogni goccia spremuta da Soul sia perfetta.

NOT NEED A MANUAL
IT IS VERY SIMPLE

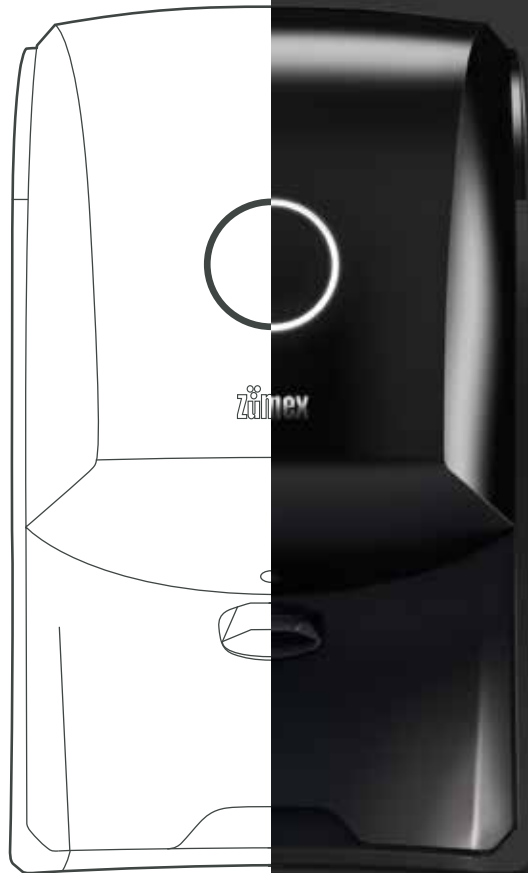

SHALL WE START?

- 16 Prepare the place where you are going to put your Soul*
- 17 Some tips before you start*

LET'S GET GOING!

- 18 Push&juice!*
- 18 Off*
- 20 Cleaning*

ANY DOUBTS?

- 24 Small problems, drastic measures*
- 26 EU Declaration of Conformity*

THIS IS SOUL AND ITS
TECHNICAL DATA

IT SQUEEZE CITRUS FRUIT

- ORANGES
- LEMONS
- LIMES

○ FRUIT SIZE
TO 80 MM

AUTONOMY FOR THE USER
FEEDER CAPACITY
3/4 FRUITS

Pat. Pend: P201331180. PCT/EP/2013/070494
Pat. Pend: P201331434. PCT/EP/2013/072340



DIMENSIONS
260 x 430 x 435 MM.

SPEED
1 JUICE IN
15"



1/MIN ≈ 12 FRUITS

WEIGHT	17kg	37.4 lb
VOLTAGE	220 V- 240 V 50/60Hz	110-120 V 50/60Hz
POWER	90W	
MAXIMUM CONSUMPTION	2.5A	5A
SOUND PRESSURE LEVEL	54dB	
ANTI-HUMIDITY PROTECTION	IPX0	

*Contact your Distributor for any technical questions you might have.

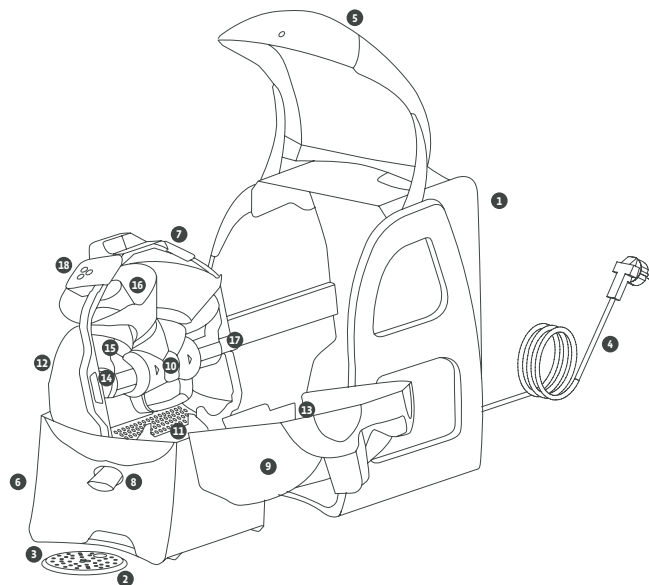

1	ZUMEX SOUL	10	SHAFT UNIT WITH CENTRE SUPPORT
2	GLASS HOLDER BASE	11	FILTER
3	GLASS HOLDER	12	JUICE EXTRACTION BASE
4	POWER CABLE	13	FEEDER FLANGE
5	FRONT DOOR	14	PRESSING UNIT FASTENER
6	WASTE CONTAINER	15	LOWER PRESSING UNIT
7	JUICE EXTRACTION UNIT	16	UPPER PRESSING UNIT
8	TAP	17	DRIVE SHAFT COUPLING
9	JUICE EXTRACTION UNIT COVER	18	JUICE EXTRACTION UNIT COVER FASTENERS

Before you start, for your safety, take into account

The specific details about your Zumex Soul juicer (voltage, frequency and other data of interest), can be found on the Identification Label that you will find inside the machine.

If you have any technical queries, you must get in touch with your **regular Dealer / Official Technical Support Service**, always stating the Serial Number on the machine Identification Label.

Zumex adopts the necessary measures to ensure that the machines placed on the market are selectively collected and managed in an environmentally respectful manner. Please contact your authorised Zumex dealer to correctly dispose of these machines.

This is not a toy, so prevent children from playing with the appliance.

This appliance can be used by children over the age of 8 or older, if they are supervised or if they have received instructions relating to the safe use of the appliance and they can understand the risks entailed. User cleaning and maintenance must not be carried out by children, unless they are 8 years of age or older and they are supervised. Keep the appliance and its cable out of reach of children under the age of 8.

This appliance can be used by people with impaired physical, sensorial or mental capacities or who lack experience or knowledge, if they are supervised or have received adequate training with respect to the safe operation of the appliance and they understand the risks entailed.

This machine is **designed for squeezing citrus fruit of the sizes indicated in this manual**. Do not use other different fruit or sizes to those specified in the manual.

Before cleaning the machine or carrying out any maintenance, always unplug from the mains.

Be very careful with the cutting elements, to avoid possible accidents.

The parts that are in contact with food must be cleaned according to the instructions that you can read in the cleaning chapter.

If the power cable is damaged, it must be replaced with an original power supply cable from the same manufacturer, in order to avoid hazards.

Do not operate the machine from behind, or try to get it to work without safety elements.

This appliance is intended to be used in household and similar applications such as:

- Staff kitchen areas in shops, offices and other working environments;
- Farm houses;
- By clients in hotels, motels and other residential type environments;
- Bed and breakfast type environments.

The instructions may be updated without prior notice. You can consult them at any time on our website www.zumex.com, in the section on the selected model.

If you have any suggestions or comments that you believe may improve our machines or service network, please get in touch with Zumex directly at the address below:

 ZUMEX GROUP, S.A. Polígono Ind. Moncada III C/Molí 2. 46113 Moncada. Valencia. Spain.
Tel. +34 961 301 251 Fax: +34 961 301 255 / zumex@zumex.com / www.zumex.com

Shall we start?

PREPARE THE PLACE WHERE YOU ARE GOING TO PUT YOUR SOUL

Have you thought about where you are going to put your machine? You can put it wherever you want and easily move it whenever you want thanks to its 360° design and light weight.

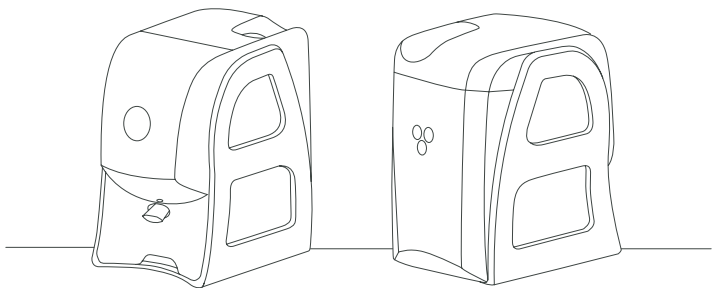

- 1 Firstly, make sure that the mains voltage coincide with the indications given on the machine identification label that you will find both on the front page of this manual and on the actual machine.
- 2 Ensure that no obstacles hinder you during the unpacking process.
- 3 Then, take the **Zumex Soul** out of its packaging and put it on the flat surface that you have prepared.
- 4 The following components may come separate, and if so, you must put them in their place: **Glass holder base**, **Glass holder**, **Power cable**.

SOME TIPS BEFORE YOU START

You are a step away from starting to extract juice with Soul. First of all, we are going to give you some tips for you to have a perfect knowledge of your new juicer.

Initial cleaning

Before using for the first time, we recommend you clean the juice extraction system. See “Cleaning” section.

Start-up

Check the electrical data of your machine with the electricity supply. Once the machine is installed correctly, plug it into the mains.

After plugging the machine in, press the button for 1" to switch on the juicer until a fixed white light appears. This means that the machine is ready to extract juice.

Check that the **Waste container** and **Front door** have been correctly fitted; otherwise a flashing white light will appear.

Remember to open the **Tap** (lower position) and put a glass under the juice outlet of your machine.

Place the **Glass holder** under the tap first.

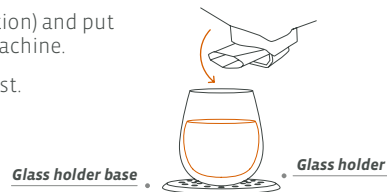

Juice extraction unit

Check that all the elements of the **Juice extraction unit** have been mounted correctly.

Loading the feeder

The machine is ready to admit 3 oranges in the feeder, according to the size.

Waste area

Make sure that the **Waste container** is correctly in place.

Let's get going!

PUSH&JUICE!

To extract juice just press the front button. You will see that the colour of the button will automatically change from white to orange.

**The juice outlet will light up:
You are preparing the most exquisite juice.**



OFF

You can switch off your machine as follows:

- a** By pressing the front button for 2".
- b** By directly disconnecting the power cable.

*If the machine does not detect oranges,
it will stop approximately 20" after the last orange has passed through.*

What does Soul want to tell me?

OBSERVE THE LIGHT ON THE BUTTON AND THE SOUND OF THE MACHINE

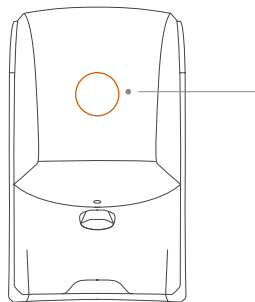

WHITE

the machine is ready to extract juice.



FLASHING WHITE

check if the waste container badly fitted, the front door open or there is an external element blocking the system.



ORANGE

the machine is extracting juice correctly.



FLASHING ORANGE

the machine is extracting juice and the waste container needs to be emptied.



The machine will warn you with a sound/beep when the waste container is full and needs emptying.



Important! Please never try to access the extraction area from the feeder with your hand, to avoid possible accidents.



Never operate the machine from one side or from the rear. You must always load the feeder from the front of the machine.



CLEANING

- 1 Disconnect the machine from the mains and remove possible obstacles around the machine.
- 2 Raise the **Front door** as far as it will go.
To close it, lower gently until you hear a slight click.
- ! **Important!** For safety reasons, if the door is not properly closed, the machine will not start up. (A)
- 3 Remove the **Waste container** to empty the peel.
To fit it back in again make sure that the **Tap** is closed (upper position) to avoid knocks. (B)
- 4 To remove the **Juice extraction unit** make sure that the **Tap** is in closed position. Hold the **handle** (a) and carefully pull outwards until you can grasp the **upper grip** (b) with the other hand. Pull the juice extraction unit out, sliding it along the guides until it is fully released, keeping it in the same position to prevent it from dripping. To put the **Juice extraction unit** back in again, take the guide that is on the left of the chassis as reference and insert the unit as far as it will go.
- 5 Carefully rest the **Juice extraction unit** on a flat surface to dismantle it, resting the left-hand side and leaving the fasteners on that same side.
- 6 Open the fasteners to remove the **Juice Extraction unit cover** for cleaning, pulling upwards as indicated in the drawing, taking care with the flanges.

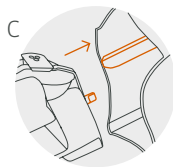
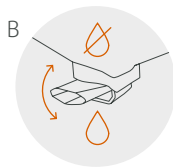
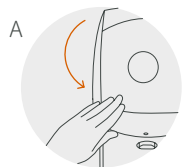

1

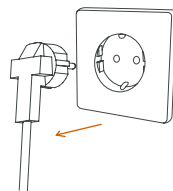

2

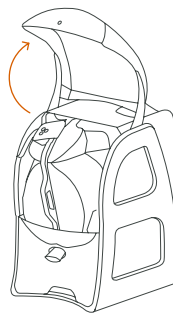

3



4

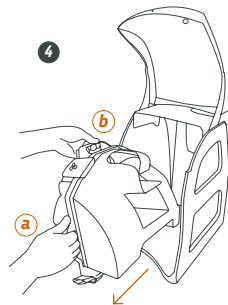

5

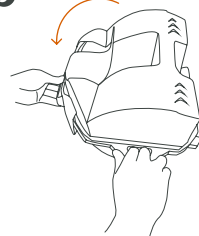

6

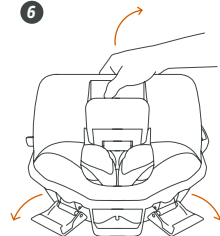

Zumex recommends cleaning the machine at least once or twice a day, depending on how much it is used in order to maintain optimal food hygiene conditions.

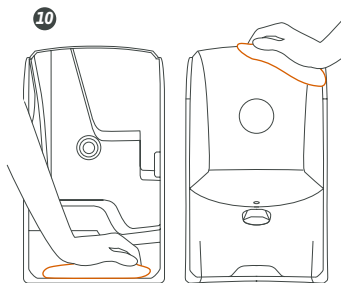
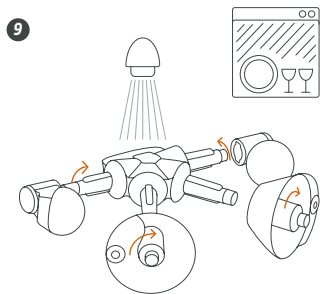
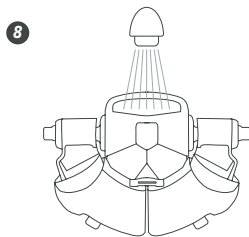
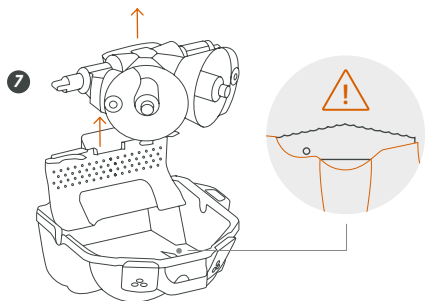

Zumex recommends using CITROCLEAN to improve the cleaning results of the machine, especially to eliminate waxes.

- 7 After removing the lid, take out the **Filter** using the adhesive flange. Then remove the entire pressing unit and shafts, pulling the grip upwards from its central support.

Warning! Be careful with the cutting area!
Be careful with the blade when removing the pressing unit and shafts.

Important! Do not pull the soft ejectors from the filter.

If you consider it necessary, you can also remove the **Feeder flange**, situated on the other cover of the **Juice extraction unit**.

Always remember to put the parts back correctly after cleaning for correct juice extraction.

- 8 Cleaning is easy. Rinse the parts with water using your hand or a sponge to remove the remains of pulp.
- 9 To remove the **Pressing units** for in-depth cleaning of their parts, turn **the Fasteners** of the **pressing units** a quarter of a turn to remove the **Lower pressing unit** and the **Upper pressing unit**.

You can also put the parts in the dishwasher. You must use the soap, salt and brightener correctly, so that the parts remain shiny.

Important! **The Shaft unit** with its central support is an indivisible unit. You must not remove it.





*To assemble, slide the respective pressing unit along the guide until it is in place. Make sure that both pressing units couple perfectly. Turn the **Fasteners** of the pressing units a quarter of a turn and make sure that the fasteners correctly secure the pressing units.*

- 10 If necessary, you can clean the inside of the metal chassis with a soapy cloth. Then, rinse and dry. Do not use a rough cloth as this may damage the machine surface. To clean the outside of the machine, you can use a damp cloth or a soapy sponge – with neutral soap.

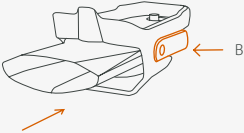
Any doubts?

SMALL PROBLEMS, DRASTIC MEASURES. *Faq*

WHAT HAPPENS TO MY SOUL?	HOW CAN I SOLVE?
<p>My Zumex Soul does not come on</p> 	<p>Check that the connection is live and that there is voltage in the socket. Connect another appliance to the socket and check it works. If the current connection is correct, check that you have connected the plug correctly into the socket, and into the machine. Check the fuse. If the button still does not come on, or flash, touch the button. If the machine does not respond, replace the fuse with the extra one, which is right next to it.</p>
<p>My machine does not extract juice There is no light on the button</p>	<p>Check that the machine is connected and touch the button.</p> <p>Access the Juice extraction unit to check that it is not jammed.</p>
<p>No juice comes out of the tap</p> 	<p>If juice still does not come out, remove and clean the tap and make sure that it is open. You can check this by pouring a glass of water into the system through the feeder area. Check that the inner filter is not jammed and clean it.</p> <p>To remove the Tap press the rear flanges to be able to unclip the tap. (B)</p> <p>To put it back on again, match up the openings of the tap support.</p>
<p>It makes a noise but no oranges go in</p>	<p>Stop the machine and dismantle it. Assemble it again following the steps and checking that all the parts fit perfectly.</p>

WHAT HAPPENS TO MY SOUL?	HOW CAN I SOLVE?
<p>Why does a white light appear on the front button?</p> 	<p>This light indicates that the machine is ready to extract juice. No fault.</p>
<p>Why does a flashing white light appear?</p>  	<p>This light appears when the machine is not extracting juice, and:</p> <p>The Waste container is badly fitted.</p> <p>The Front door is not closed correctly.</p> <p>There is an external element blocking the system.</p> <p>If the button does not stop flashing, verify these points well and make sure that the container is perfectly clean and that there is no dirt in the detection area. (A)</p>
<p>Why does an orange light appear on the front button?</p> 	<p>This light indicates that the machine is extracting juice correctly. No fault.</p>
<p>Why does a flashing orange light appear with a warning sound?</p> 	<p>When the Waste container is full of peel, the machine will inform of this with a flashing orange light and an intermittent beep.</p> <p>From that moment, the machine will only squeeze 2 more oranges. After that it will stop, and a white light will appear on the button.</p> <p>If you try to continue extracting juice and press the button again, the machine will not start up and will give a warning via a continuous and more prolonged beep. For it to work normally again, please empty the Waste container.</p>

EU DECLARATION OF CONFORMITY

ZUMEX GROUP S.A., whose registered offices are situated at Polígono Industrial de Moncada III, C/ Molí, 2 - 46113 - Moncada, Valencia (Spain) does here by declare, under its sole responsibility, that the **Zumex Soul** juicer machine models conform to the following harmonised standards:

EN 60335-1	2012	Safety of household electrical appliances and similar. Part 1: General requirements
EN 60335-2-14 + A1 + A11	2006 2008 2012	Household and similar electrical appliances. Safety. Part 2-14: Particular requirements for kitchen machines
EN 62233	2008	Measurement methods for electromagnetic fields of household appliances and similar apparatus with regard to human exposure
EN 55014-1 + A1 + A2	2006 2009 2011	Electromagnetic compatibility. Requirements for household appliances, electric tools and similar apparatus. Part 1: Emission
EN 55014-2 + A1 + A2	1997 2001 2008	Electromagnetic compatibility. Requirements for household appliances, electric tools and similar apparatus. Part 2: Immunity. Product family standard
EN 61000-3-2 + A1 + A2	2006 2009 2009	Electromagnetic compatibility (EMC). Part 3-2: Limits. Limits for harmonic current emissions (equipment input current ≤ 16 A per phase)
EN 61000-3-3	2008	Electromagnetic compatibility (EMC). Part 3-3: Limits. Limitation of voltage changes, voltage fluctuations and flicker in public low-voltage supply systems, for equipment with rated current ≤ 16 A per phase and not subject to conditional connection
NSF/ANSI 8	2012	National Sanitation Foundation. Commercial powered food preparation equipments
NSF/ANSI 51	2014	National Sanitation Foundation. Food equipment materials

Copying with the provisions of the European Directives set out below:

2006/42/UE	Security on machinery
2014/34/UE	Electrical equipment designed for use within certain voltage limits
2014/30/UE	Electromagnetic compatibility (EMC)
2008/39/UE	Plastic materials and articles intended to come into contact with foodstuffs
2011/65/UE	Restriction of the use of certain hazardous substances in electrical and electronic equipment (ROHS)
2012/19/UE	Waste electrical and electronic equipment (WEEE)
REG.(EC) N° 2023/2006	Good manufacturing practice for materials and articles intended to come into contact with food
REG.(EC) N° 1935/2004	Materials and articles intended to come into contact with food

Moncada, March 23, 2016



Maria José Ramón
Quality Manager

Get in touch with us

If the anomalies indicated persist, please do not hesitate to get in touch with our Technical Service. We will be delighted to help you.

Consult our website **www.zumex.com** where you will find all the information about Zumex Service as well as the Service Partner contact information in each country.

If you wish, you can contact us:

ZUMEX SERVICE

Tel. +34 96 080 0999

service@zumex.com

Or enter the website, in the online Support section.

*Welcome to the new era of simplicity,
we hope you will enjoy your Soul juicer.*

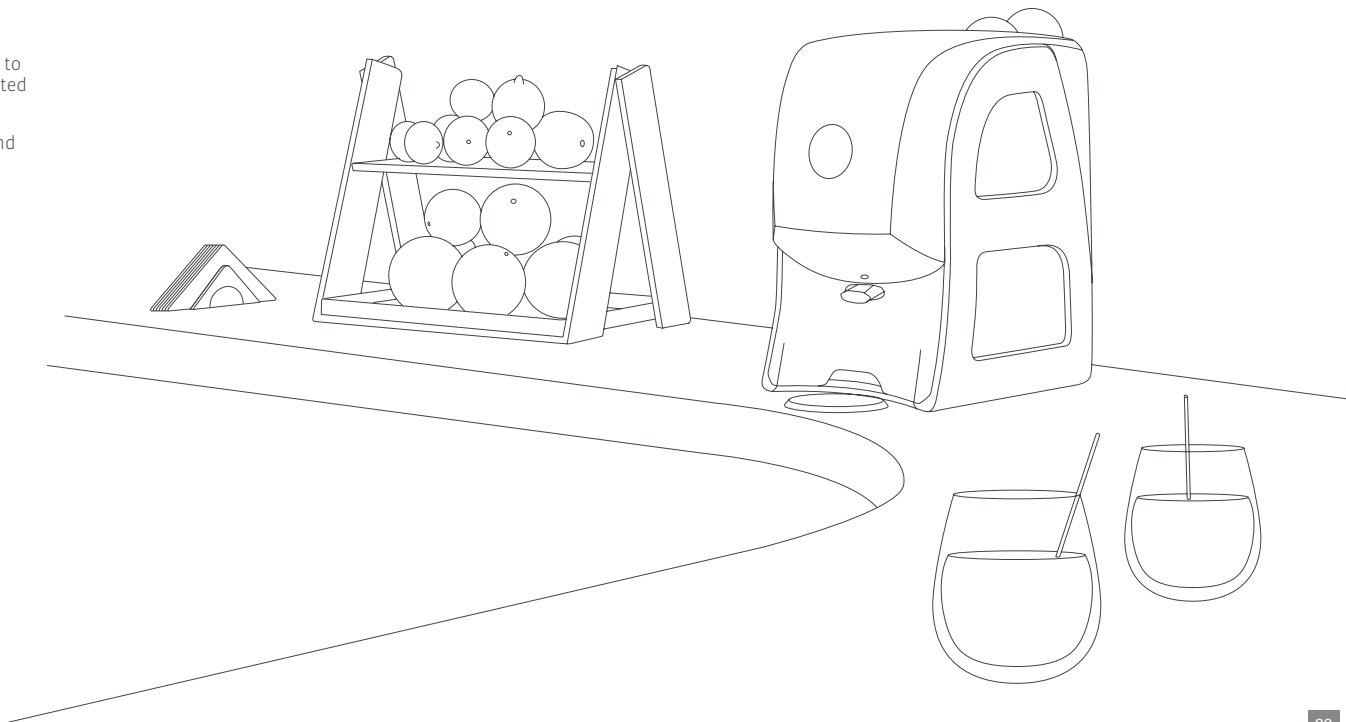

SOUL.

ENJUICE YOUR LIFE

❖ enjuiceyourlife.com

zümex®

Pat. Pend: P201331180 Pat. Pend: PCT/EP/2013/070494
Pat. Pend: P201331434 Pat. Pend: PCT/EP2013/072340 Design Pat Pend.

