

CLEANING INSTRUCTIONS
SPEED PRO SELF SERVICE PODIUM

Caution! For a correct cleaning process please follow the instructions below. Make sure machine is unplugged from electrical current.



1 Take off the feeder basket.



2 **Drain&Clean.** Drain system that makes easier to clean the feeder.

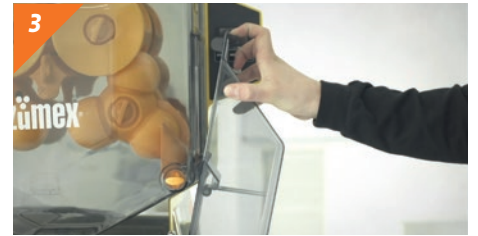

3 Take out the cover sides. Turn the lock / extract the peel guides.



4 Take off front cover. The fixed **Click&Clean** lugs help clean and handle the machine.



5 Take out the inox peel bucket.



6 Take out the **PulpOut** system.



7 Remove the **2Services** tap. Easy to dismantle.

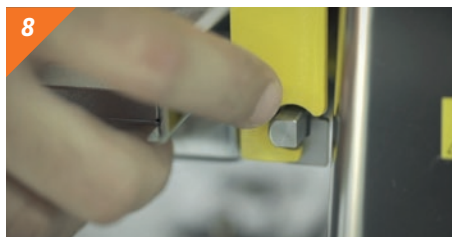

8 Press the lateral button to extract the steel bin. Removable in just one click.

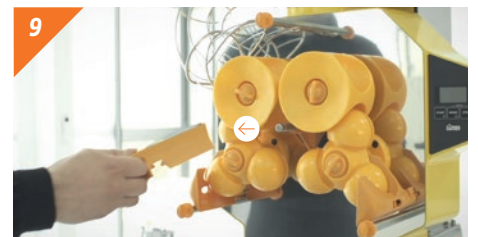

9 Extract the knife by pulling it towards you. **CAUTION!** The blade is very sharp, be careful not to cut yourself.



10 Pull off the peel ejectors.

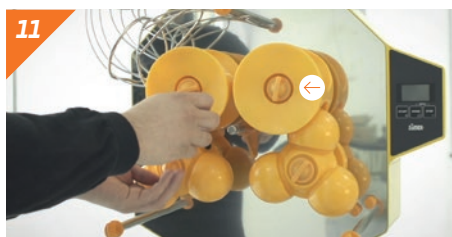

11 Unscrew the securing knobs of the pressing units.



12 Take off the pressing units in pairs.



13 Empty waste trolley.



14 Clean parts.

! INFORMATION

All pieces, **EXCEPT THE FRONT COVER**, can be cleaned in a dishwasher.

The juice extraction zone and the front cover should be cleaned using a moist cloth and dish washing liquid. Rinse with clean water to remove any washing liquid traces.

Citroclean is perfect to clean the parts in contact with fresh products.

To assemble the machine repeat the process in reverse and ready to work.